

AUTOMATIC LIFTING HOOK IS



Automatically hooks up, safety locks and releases. The risk for injury is dramatically reduced. No climbing or helpers injured or squeezed by the load in the dangerous loading or drop zone.

NEW CONCEPT SAVES TIME AND INCREASES SAFETY

Lifting operations with mobile cranes and industrial hoists can safely be managed by the operator alone. He can remain at the controls during lifting and release operation.

The IS Hook is available in 5 sizes from 2 to 20 tons. It is easy to operate, has rugged design and a high reliability.

HOOK UP

Lifting eye or sling.

The IS consists of hook, housing and link. Forged hook, housing and link are of high-grade alloy steel.

LIFT

When the IS Hook is engaged, the load tension automatically *safety locks* the hook and housing assembly.

Unloaded, the spring loaded hook is pulled up against the housing in an open, ready-to-load position where it can easily be hooked onto a sling, lifting eye or other attach hardware.

LOWER

After completed lifting operation the IS Hook is lowered until it tilts into release position and opens.

When the IS Hook is engaged, the load tension closes the hook opening, and the safety latch is automatically locked.

RELEASE

The IS Hook automatically frees itself from the load and is then ready for the next lifting operation.

The hook remains safety locked even if it is unloaded. It is therefore possible to safely set down the load and make sling adjustments.

To release the safety lock after completed lifting operation the hook is lowered until the upper link has tilted approx. 60° in relation to the housing. When the lock is released, the hook swings up into an open starting position. The load is released, and the hook is ready for a new lifting operation.

The IS Hook is tested and approved by the Swedish Institute for Materials Testing.

Transport case is optional.

APPLICATIONS

Blasting mats, pipes, pumps, machines, gas bottles, big bags and general lifting.



PIAB™

Force Measurement

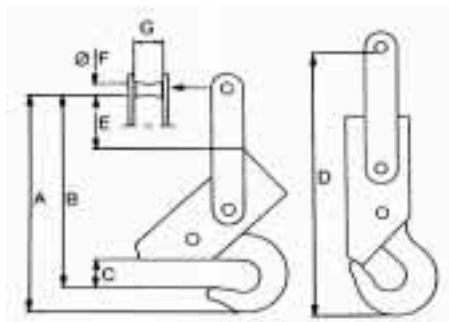

IS	WORKING LOAD LIMIT TON		DIMENSIONES MM							WEIGHT APPROX. KG
	SAFETY FACTOR 4:1	SAFETY FACTOR 5:1	A	B	C	D	E	F	G	
2	2	1.6	310	280	60	340	80	20	42	3.0
5	5	4.2	360	325	50	430	90	32	54	6.7
10	10	8	490	425	65	580	110	44	58	15
15	15	12	525	460	80	625	115	54	72	24
20	20	16	580	500	80	700	130	65	83	37

Dimensions subject to change without notice.